

# MP-150 Mid-HF Transducer System

*Acoustic Power Output.....*

- 143-145 dB, 100 Hz - 400 Hz

- 140 - 142 dB, 100 Hz - 2 kHz

*Input Connection.....Neutrik NL8*

*Dimensions (per cabinet).....47.67" x 29.84" x 16.06"*

*.....(1211mm x 758mm x 408mm)*

*Weight.....300 lbs. (136.1 kg)*

*Enclosure Material.....Baltic Birch (void-free)*

*Coat.....Catalyzed Urethane (cabinet)*

*.....Polyurethane powder-coat (metal)*

Patents Issued & Pending, see: <https://msi-dfat.com/patents>



*MP-150  
Transport  
Cart:*

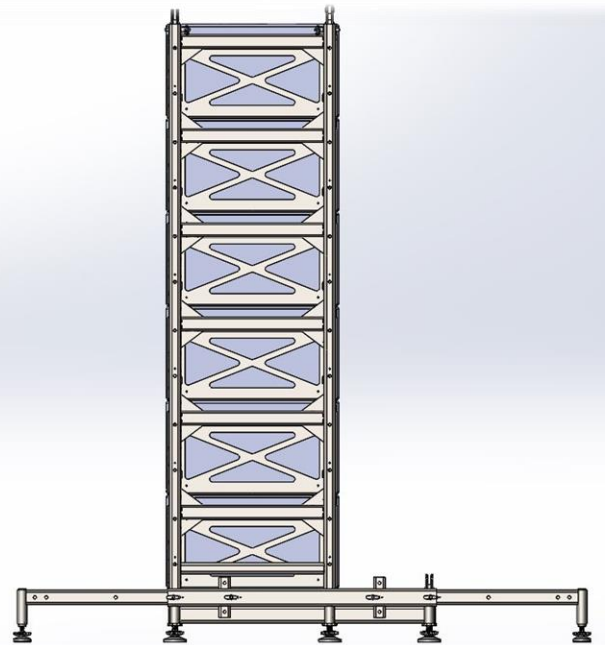
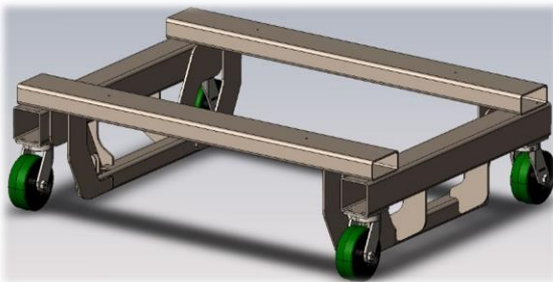

**ACCESSORIES:**

Base Frame: 48" x 58.3" x 8.5" (1218.5mm x 1480.8mm x 216mm), 352 lbs. (159.6 kg)

Transport Cart: 47.75" x 49.8" x 8.5" (1212.9mm x 1265mm x 216mm), 545 lbs. (247.2 kg)

Lift Frame: 46" x 58.5" x 6" (1168.5mm x 1486mm x 152.4mm), 230 lbs. (104.3 kg)

Typical Deployment:  
Vertical as multiples of 6